

AeroMist™ Ultrasonic 24-Hour Diffusing Mister INSTRUCTIONS

PARTS

1. Cover
2. Max Water Level Line
3. Vent Hole
4. Water Tank
5. Mist Outlet
6. Water Drain Groove
7. Light Button
8. Mist Button
9. DC Jack
10. Adapter

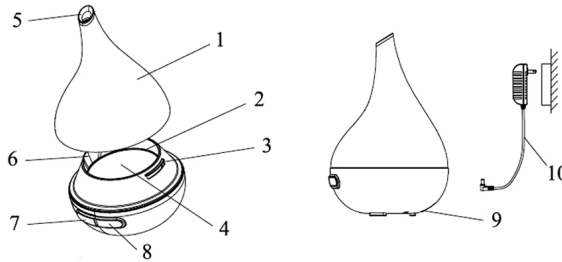

FEATURES

Lustrous PET material adds style while promoting a healthy environment. Up to 8 hours of streaming mist, and 24 hours intermittently. Colorful and brilliant with its special lighting effect.

1. Water Capacity: 200 mL (6.76 fl oz)
2. Suggested Room Size: 300-400 sq ft
3. Continuous Operation: up to 8 hours
Intermittent Operation: up to 24 hours
(20 sec ON; 40 sec OFF)
4. Light Mode: Calm pulsating special effect
5. Automatic safety shut-off
6. Power: AC adapter included, ETL approved

CARE & MAINTENANCE

Always remove the power cord before cleaning.
When not in use, empty the water and dry with a soft cloth to avoid mineral buildup.

To remove possible buildup, gently use a cotton swab dipped in alcohol to wipe out the inside.

* SpaRoom® KLENZOR™ tablets may be used to renew diffuser to like-new condition.

Note: The vibration plate should not come in contact with any hard or sharp objects.

Do not use strong cleaning agents.



INSTRUCTIONS FOR USE

1. Remove upper cover from the base (Fig 1).
2. Insert the power supply into the DC Jack and plug the AC Adapter into the wall outlet (Fig 2).
3. Fill the water tank with cool tap water to the Max Water Level Line (Fig 3). Add a few drops of your choice of essential oil (not included) into the water tank (Fig 4).
4. Replace the cover (Fig 5).
5. Button Functions (Fig 6):
Left Side – Light: 1st push special effect pulsating light; 2nd push fixed brightness; 3rd push OFF.
Right Side – Mist: 1st push continuous; 2nd push intermittent 20 seconds on / 40 seconds off; 3rd push OFF.
6. The unit will automatically shut off when water level becomes too low.
7. Use only 100% pure essential oil. It is recommended that you refresh the oil if using the unit for 24 hours.

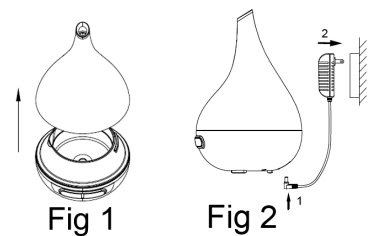

Fig 1

Fig 2



Fig 3

Fig 4

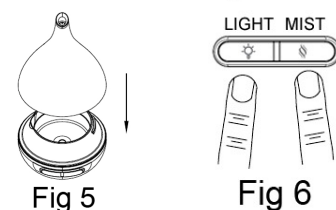

Fig 5

Fig 6